

Linssen SL series

Timeless sporty Dutch motor yachts. Since 1949...
9.70 - 16.50 m





There are buttons on almost every page. Clicking these will take you directly to the page on the Linssen website on the corresponding topic with lots of information, photos, 360-degree interiors, videos and more.

Contents

- Sustainably built for long lasting pleasure.....4
- Company history6
- The Linssen boatyard in Maasbracht.....8

- The Linssen SL series 10
- The Linssen SL Variotop® series 12

- Linssen 30 SL AC / Sedan 14
- Linssen 35 SL AC / Sedan 20
- Linssen 40 SL AC / Sedan 26
- Linssen 45 SL AC / Sedan 32

- Linssen Variotop® 38
- Linssen 50 SL AC Variotop® 40
- Linssen 55 SL AC Variotop® 42
- Linssen 50 SL Sedan Variodeck 46

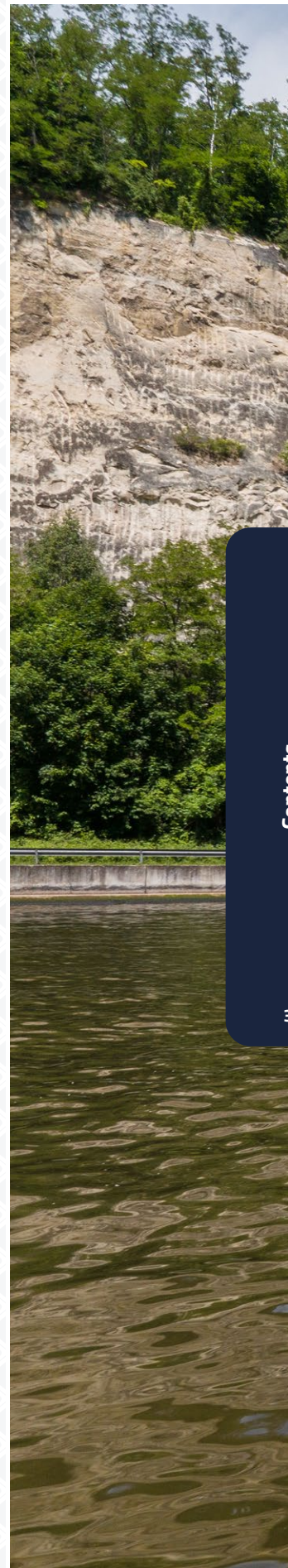



Sustainably built for long lasting pleasure

Linssen since 1949...

Our founder Jac. Linssen grew up at a time when it was considered a mortal sin to throw anything away. Thrift was the order of the day. Everything could be reused.

In our time, the disposable industry has taken on massive proportions, unfortunately. Cheap Chinese exports are flooding our country, with quality increasingly taking second place.

But not at Linssen Yachts. The fact that we are European market leaders is directly linked to our ethos of quality. Because if you think and work on the basis of quality, sustainability will automatically follow in its wake.

"The best way to be sustainable is to develop a product that does not need to be recycled."

- Jos Linssen -



Steel can be fully recycled after 50 years and start a second life as a raw material for new products.

It may sound strange, but our steel yachts are green at heart. And greener than yachts built from other materials. Linssen pleasure yachts are quality products that hold their value. Or as Jos Linssen likes to put it: "We make tools, not toys."

In essence, what we do at Linssen Yachts today is not much different from what Jac. Linssen did in his day. He, too, selected the best materials, used them efficiently and cared about the people, companies and associations around him. The only difference is that this is now called Responsible Business Conduct (RBC). We interpret this term in our own judicious way.

Conscious and responsible handling of raw materials, water, energy and waste streams has become automatic in our company. Take the high-quality materials we use in our interiors. These, like the steel that forms the foundation of our yachts, are fully recyclable. And not

unimportantly: they are correct material flows whose origin we have fully traced. For example, we only use sustainable teak wood from tree plantations to prevent scarcity and deforestation.

Waste management has been an integral part of our business operations for years. All the waste streams within our production facilities are separated, broken up and disposed of for recycling. Plastic by plastic. Wood by wood. Steel by steel. Batteries are returned to the battery factory. We treat residual liquids from our coating processes, such as thinners, and reuse them for rinsing pipes, for example.

Our predecessors have always set us a good example. Their ideas on quality and sustainability have been passed down from generation to generation in our family business. And this will continue for generations to come.



"Always try to give your customers a bit more than you promised them. In this way you will win loyal customers."

Jac. Linssen sr.

** 24.01.1922 - † 19.03.2020*



As a family business, we are guided by respect for people, the environment and by an appreciation of fine materials. And it is that passion that enables us to create an added value that goes beyond a 'good product'. In that sense, we not only build luxury motor yachts at our premises in Maasbracht and Echt, we also make dreams come true.

The unparalleled symbiosis of the specific choice of materials, the consistent design, the admirable professionalism of our staff in combination with state-of-the-art processes and machines, make these motor yachts built in Limburg into an authentic and unique Linssen!

Company history

Linssen Yachts is one of the oldest yacht builders in the Netherlands. So it's a company with a rich tradition. The business was established in 1949 by Jac. Linssen Sr. (†) in Maasbracht, a small but dynamic harbour town on the River Meuse in Limburg, in the heart of the largest continuous boating area in the Netherlands, the Maasplassen lakes.

Linssen Yachts has now become the market leader in Europe for the construction of steel yachts and produces approximately 70 yachts between 9 and 16 metres each year entirely in-house.





The Linssen boatyard

The Linssen boatyard is an imposing complex of over 45,000 m² in area. Spread over two locations (Maasbracht and Echt), all production is in-house.

If you are interested in a Linssen yacht and are visiting the boatyard, one of our staff will be pleased to show you our production line. You will be amazed by the huge variety of yachts.

This is a particularly impressive process, which cannot be properly explained on paper. You really have to see it to appreciate it.

Linssen Yachts has about 30-35 yachts in production at any one time.



- 5. Preservation department
- 6. Spray booths (2x)
- 7. Logiwood; CNC-techniques
- 8. Logiwood; interior modules
- 9. Logicam I production line (30'-35' Grand Sturdy & SL, engine room/interior)
- 10. Logicam II production line (40'-45' Grand Sturdy & SL, engine room/interior)
- 11. Logicam III production line (450/500/550 Variotop/ Variodeck, engine room/interior)

1. Reception
Showroom
Upper Deck



2. Product development
Research & Development (prototyping)
After sales



3. Hull construction

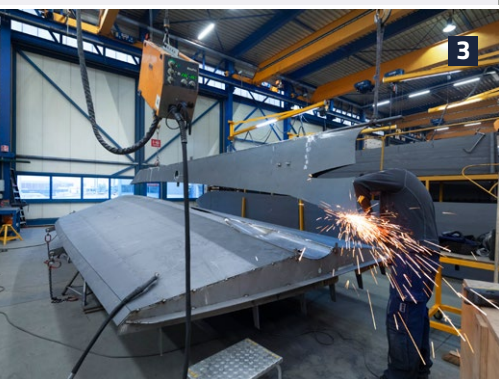

4. Blasting cabin



12. Marina



The Linssen SL series

Passion, endurance, and refinement: the SL is the mark of a Linssen that has been developed for the most discerning enthusiasts of sporting lifestyle.

SL is an acronym for Sport Luxury. A series of yachts that combine the unmistakably luxurious Linssen identity with enhancements that adhere to the greatest sporting traditions.

There are four different Linssen SL models to choose from in both AC and Sedan version:

- Linssen 30 SL AC / Sedan
- Linssen 35 SL AC / Sedan
- Linssen 40 SL AC / Sedan
- Linssen 45 SL AC / Sedan



Linssen 30 SL AC



Linssen 35 SL AC



Linssen 30 SL Sedan

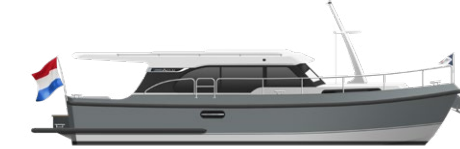

Linssen 35 SL Sedan



Linssen 40 SL AC

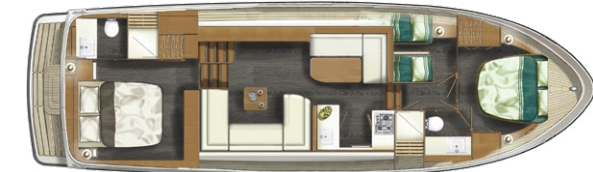
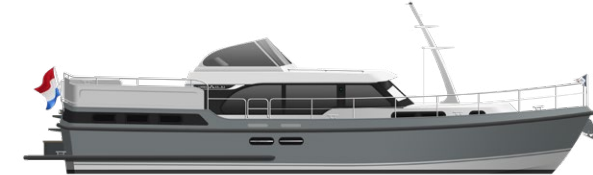

Linssen 45 SL AC



Linssen 40 SL Sedan

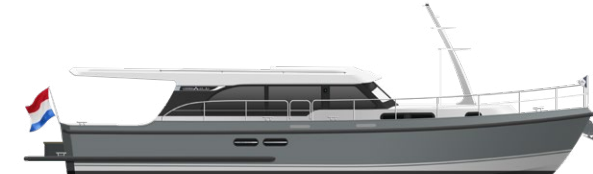

Linssen 45 SL Sedan

Standard:

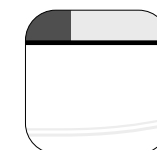

Egg shell White

Options:

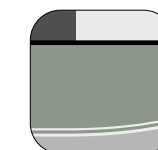

Cove Green

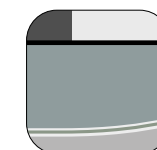

Fjord Blue

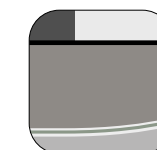

Haven Grey



The Linssen SL Variotop® series

The Variotop® is a folding roof that covers the wheelhouse so that it is completely watertight and insulated thanks to ingenious locking and sealing systems. Close the Variotop® and the wheelhouse doors and the open helmsman's position is instantly transformed into a heated Variotop® wheelhouse where it is a pleasure to be. On a warm summer's day, just cruising along, the boat gently rolling at anchor or leisurely

moored to the quay, the Variotop® – now like a fully fledged bimini top – provides wonderful cool shade.

The Linssen SL yachts with Variotop® are available in 2 lengths:

- the Linssen 50 SL AC Variotop®
- the Linssen 55 SL AC Variotop®

VARIOTOP®
ONE TOUCH CABRIO



Linssen 50 SL AC Variotop®



Layout 1



Layout 2



Linssen 55 SL AC Variotop®



Layout 1



Layout 2



Linssen 50 SL Sedan Variodeck

Standard:

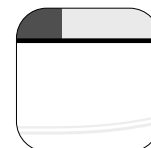

Egg shell White

Options:



Cove Green

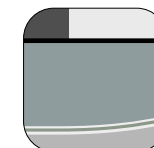

Fjord Blue



Haven Grey



Linssen 30 SL Sedan / AC

A compact Linssen with an exceptionally sporty appearance. The Linssen 30 SL is the entry-level boat in our SL (Sport Luxury) series. It has the distinctive qualities and sailing characteristics that we give to all our motor yachts. At the same time, it's a yacht with a design and interior that represents a new trend in our range. Designed and made for lovers of a sporty lifestyle. And available in an AC version (with aft cabin) or Sedan version (with open cockpit).

Our 30-footer from the SL-series is the ideal yacht from which to take your first step into the world of water sports. A stable, comfortable and extremely manoeuvrable travelling companion on which you can explore the European inland waterways at your leisure. And you don't have to miss out on a boat trip along the coast either.





Layout Linssen 30 SL Sedan

± 9,70 x 3,30 x 1,00 m

2 (+2)

± 1,83 / 1,94 m



Layout Linssen 30 SL AC

- ± 9,70 x 3,30 x 1,00 m
- 4 (+2)
- ± 1,83 / 1,94 / 1,87 m



Linssen 35 SL Sedan/AC

If you want to go one step higher in our SL series, you'll find the Linssen 35 SL. It's "only" one metre longer than its little sister the 30 SL, but that makes it the perfect sporty yacht for you and your family. Especially if you go for the AC version, with 2 spacious double bedrooms. If the yacht is going to be the second home for you and your partner, the Sedan version will probably be your first choice.

There's no lack of space in either version. You can see and feel how spacious they are, especially in the

saloon with its upgraded interior. On the outside of the 35 SL the anthracite colour accents in the window frames and jambs are eye-catching.

The sailing characteristics of the 35 SL are also cutting-edge and state-of-the-art. It takes little effort to sail and manoeuvre this yacht. Like the other members of the SL family, the 35 SL has excellent handling, even in reverse.





Layout Linssen 35 SL Sedan

- ± 10,70 x 3,30 x 1,00 m
- 2 (+2)
- ± 1,83 / 1,94 m



Linssen 35 SL AC

24

Linssen 35 SL AC

25



- ± 10,70 x 3,30 x 1,00 m
- 4 (+2)
- ± 1,83 / 1,94 / 1,87 m

Layout Linssen 35 SL AC



Linssen 40 SL Sedan/AC

Those familiar with Linssen history will see that our SL Series is indebted to the sporty model series we produced in the past (SE/SX). The only difference with this SL-series is that we haven't translated its sporty character into speed but into looks. The 40 SL, which is available as an AC version and a Sedan version, shows this in all its glory. It's a generously proportioned yacht with plenty of living space, as well as space for storage and relaxation on board.

The layouts of the AC and the Sedan are functional and accurately designed to accommodate the

number of users and intended purposes. The interior perfectly matches the modern exterior with its clean lines and balanced colour palette.

The 40 SL Sedan has the Linssen Slide and Pop Out Door (LSP®) on the port side next to the helmsman's position.

Whichever version of the 40 SL you choose, you'll get plenty of comfort and space, with an eye for refinement "wrapped" in a sporty design.





Layout Linssen 40 SL Sedan

± 12,85 x 4,25 x 1,20 m

4 (+2)

± 1,97 / 2,01 m



Linssen 40 SL AC

30

Linssen 40 SL AC

31



Layout Linssen 40 SL AC

± 12,85 x 4,25 x 1,20 m

6 (+2)

± 1,97 / 2,01 / 1,99 m



Linssen 45 SL Sedan/AC

Spacious. More spacious. Most spacious. The Linssen 45 SL has an elegant appearance that is particularly suitable for longer cruises with family and friends across Europe. But of course it's also for a long weekend not so far from home.

On board the 45 SL you'll experience the luxury of space. And you'll find plenty of space for luxury. The functional layout and optimum use of the available square metres make every room a comfortable

place to be. Everything you need is there and everything you bring from home on your trips can be easily stored.

The 45 SL is also available as an AC version with aft cabin and a Sedan version with a spacious open cockpit. The choice is yours and it's a very personal one.





Linssen 45 SL Sedan

34

Linssen 45 SL Sedan

35

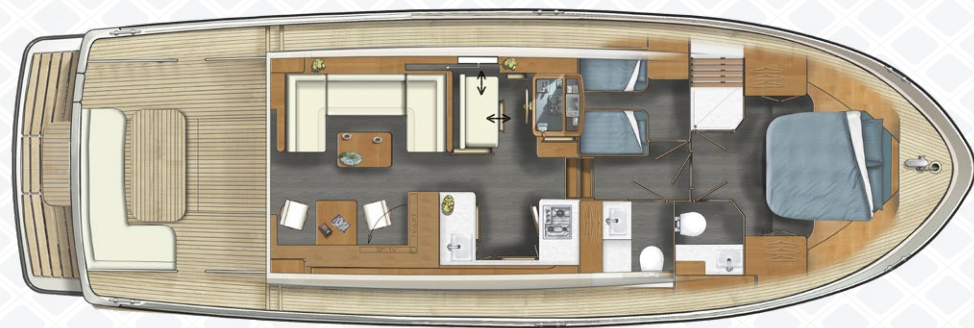

- ± 13,98 x 4,30 x 1,20 m
- 4 (+2)
- ± 1,97 / 2,01 m

Layout Linssen 45 SL Sedan



Linssen 45 SL AC

36

Linssen 45 SL AC

37

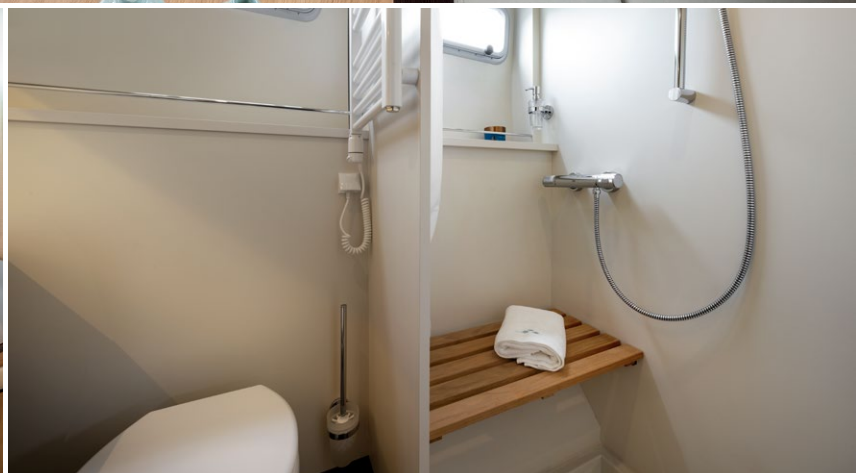
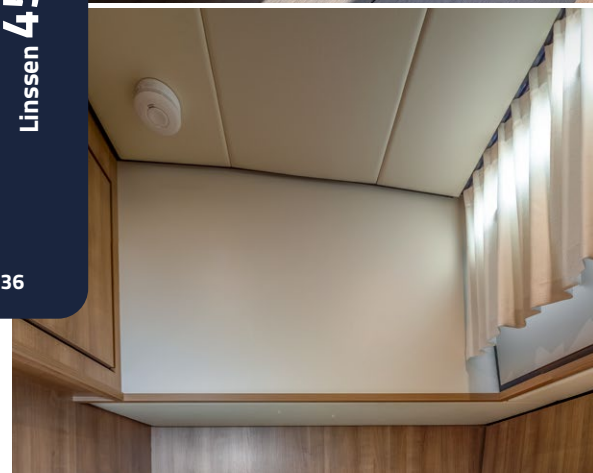

Layout Linssen 45 SL AC

± 13,98 x 4,30 x 1,20 m

6 (+2)

± 1,97 / 2,01 / 1,99 m



The Linssen Variotop®

A yacht equipped with a Linssen Variotop® is actually a very special combination of an inside and outside helmsman's position and a fly-bridge. With a Variotop® you are sailing 'outdoors' and you can combine the aft deck or open cockpit with the wheelhouse to form one big external space. If the weather gods are less well disposed towards you, just close the Variotop®, and you will actually be connecting the helmsman's position to the aft cabin, creating an impressive internal space. In this way the Variotop® unites the compartments and

therefore the crew. This makes the yacht suitable for all seasons and ensures a great experience while cruising. The Linssen-Variotop® offers a perfect balance between functionality, comfort and design.

Doordacht detail: de beugel waarin de Variotop® bij openen verdwijnt, kan worden neergeklapt. Op die manier verkleint u de doorvaarthoogte en vergroot u uw vaargebied.

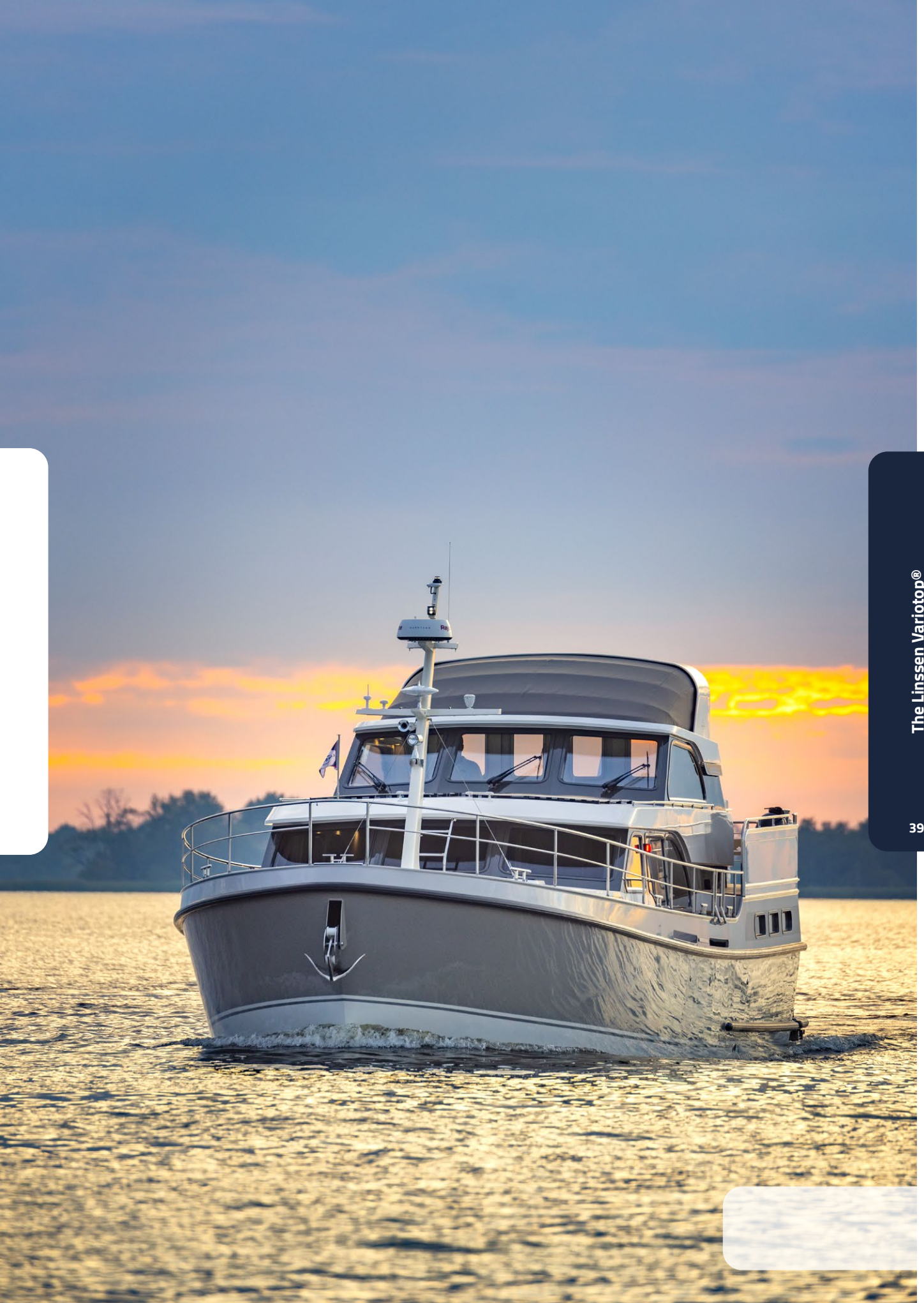



under development

Artists impressions



Linssen 50 AC Variotop®

40

Linssen 50 AC Variotop®

41



Interior pictures Grand Sturdy 500 AC Variotop®

Layout 1



Layout 2



- ± 15,50 x 4,65 x 1,20 m
- 6
- ± 2,00/1,98/1,98 / 2,00 m

Layout Linssen 50 SL AC Variotop®





Layout 1



Layout 2



- ± 16,45 x 4,88 x 1,29 m
- 6
- ± 2,00/2,00/2,00 /2,00 m

Layout Linssen 55 SL AC Variotop®



Artists impressions

under development



Interior pictures Grand Sturdy 500 Sedan Variodeck

Linssen 50 SL Sedan Variodeck

Our largest Sedan, also for small waterways
The Linssen 50 SL Sedan Variodeck is a luxury 'traveller' with ideal dimensions. And with a more than ideal clearance height of only 2.75 m. The Linssen 50 SL Sedan Variodeck® paves the way for many comfortable cruises, even right across the French sailing mecca. This is the ultimate Linssen for skippers who like to think in terms of possibilities, not limitations.

The Linssen 50 SL Sedan Variodeck® is a genuine all-season boat that allows you to enjoy both the small and large waterways very early and very late in the sailing season. The many USPs are too numerous to mention here. Just take the large E-Variodeck sliding roof, the Bifold Variodoors between the saloon and the open cockpit, the One Touch Cockpit cover and the Smart Helm Console. All unique Linssen elements that enhance both safety and comfort and experience on board.

Linssen 50 SL Sedan Variodeck

Linssen 50 SL Sedan Variodeck



- ± 15,50 x 4,65 x 1,20 m
- 4
- ± 2,00 / 2,05 m

Layout Linssen 50 SL Sedan Variodeck

Disclaimer

De naam Linssen®, het Linssen-beeldmerk en de productnamen Linssen Sturdy, Linssen Variotop®, FIS®, Floating Panel System (FPS®), HPH®, SPH®, LIPPON®, ICCISS®, Linssen Slide and Pop-out door (LSP®), Fix Bottom Flex Sides (FBFS®), One Touch Cockpit Cover (OCC®) en Ten Main Modules (TMM®) zijn geregistreerde merken onder auteursrechtelijke bescherming.

Al onze aanbiedingen zijn vrijblijvend. Prijs- en productwijzigingen, wijzigingen van in- en exterieurtekeningen, uitrustingsstabellen en basisgegevens evenals tekstuele fouten zijn voorbehouden. Afbeeldingen, kleuren, beschrijvingen en gegevens met betrekking tot afmetingen, eigenschappen e.d. gelden enkel bij benadering en zijn niet bindend. Op de getoonde afbeeldingen komen optionele uit-

voeringen voor die niet tot het standaard leveringspakket behoren. Bij alle illustraties, Layouten en silhouettekeningen betreft het 'artist's impressions' waarvan de maatvoering kan afwijken. U kunt zich over alle Linssen-jachten uitvoerig laten informeren op onze werf of bij uw Linssen Yachts-dealer.

Alle informatie in deze catalogus is auteursrechtelijk beschermd. U mag de informatie, de tekst, de foto's e.d. in de catalogus in geen geval geheel of gedeeltelijk reproduceren, aanpassen, openbaar maken of toestemming geven voor publicatie, zonder voorafgaande schriftelijke toestemming van Linssen Yachts.

Bij het ontwerpen en samenstellen van deze catalogus is de grootst mogelijke zorgvuldigheid in acht genomen. Wij kunnen echter geen garantie geven met

betrekking tot de volledigheid en juistheid van de vermelde informatie. In het bijzonder wijzen wij u erop dat elk Linssen-jacht een uniek geproduceerd jacht is en dat er wat betreft uitrusting, Layout en samenstelling individuele afwijkingen mogelijk zijn ten opzichte van de standaards en gemiddelde maten.

Vormgeving: JJ'Style (info@jjstyle.nl)

Vertalingen: Acolad Nederland (maas-tricht@acolad.com)

Foto's: Linssen Yachts, Zebra Fotostudio, Dick van der Veer, Yachtmedia.be

© Linssen Yachts B.V. - Maasbracht, augustus 2023

SLOW DOWN... AND START LIVING



Linssen Yachts B.V. | Brouwersstraat 17, NL-6051 AA Maasbracht
+31(0)475 439 999 | www.linssenyachts.com

